

SATISFY
YOUR
CURIOSITY

IDA ANNUAL CONFERENCE

LYRATH HOTEL || KILKENNY || MAY 11-13, 2017



PLAQUE CONTROL: 'GOOD' CAN BE BETTER



THE PROVEN ORAL CARE COMBINATION

A combined analysis of 29 clinical studies on essential oils has been published in the *Journal of the American Dental Association*.

This showed that after 6 months of using **LISTERINE®**, after brushing and inter-dental cleaning, **37%** of patients had at least half their mouth free from plaque, compared with only **5.5%** of those who just brushed and used inter-dental cleaning.¹ **LISTERINE®** contains a unique anti-plaque agent, 4 powerful essential oils. These penetrate the plaque biofilm to kill **97%** of bacteria left behind after brushing.² For some patients 'good' can be better.

To see the full study visit [http://jada.ada.org/article/S0002-8177\(15\)00336-0/abstract](http://jada.ada.org/article/S0002-8177(15)00336-0/abstract)

BRING OUT THE BOLD™

Johnson & Johnson
FAMILY OF CONSUMER COMPANIES
www.listerineprofessional.co.uk

References
1. Nruogo MW, et al. *J Am Dent Assoc* 2015;146:610-622.
2. Johnson & Johnson. Data on file.
BBE/11/17-2300



A successful dental practice starts with teamwork. A precision team you build from within. And a formidable ally to help achieve exceptional outcomes for your patients and your practice. At Zimmer Biomet Dental, we've been pushing the boundaries of oral health for over 63 years now. We can do the same for you.

When you choose Zimmer Biomet Dental, extraordinary things can happen. Our heritage of quality products, innovative solutions, service and support enables you to rethink where you are and focus on where you want to be.

It's all possible with Zimmer Biomet Dental.

Expect more. Call 1 800 552 752 for more information.

zimmerbiometdental.com

All references to Zimmer Biomet Dental contained herein refer to the dental subsidiaries of Zimmer Biomet Holdings, Inc. Unless otherwise indicated, as referenced herein, all trademarks are the property of Zimmer Biomet. This material is intended for clinicians only. ZB0127 REV A 01/17
©2017 Zimmer Biomet. All rights reserved.

 **ZIMMER BIOMET**
Your progress. Our promise.™

Innovative treatment for the symptoms of TMJD.



Cerezen is an innovative, custom-made in-ear device that relieves the pain and symptoms of TMJD, bruxism and other cranial-muscular conditions.

Over 450 registered providers across Ireland and the UK.

visit www.cerezen.ie
or call 1890 20 40 20
for more information

cerezen™
comfortable relief

PRESIDENT'S WELCOME

Dear Colleague

On behalf of the Irish Dental Association, I would like to welcome you to the Annual Conference 2017.

This year we return to the Lyrath House Hotel in the Marble City of Kilkenny, which proved very popular when we last visited in 2014. You and your entire dental team are encouraged to attend over the three days and bring back some new ideas to your own dental surgeries.

At the scientific programme, I look forward to hearing world-renowned speakers from far and near covering areas of significant interest to you and your team. I am particularly pleased to welcome Dr Stephen Buchanan, endodontist, California and UCLA, who will give a full day's lecture at our pre-conference programme. Professor Jim Kessler from the University of Oklahoma will provide hands-on courses in bonded ceramic restorations, while periodontist Dr Kirk Pasquinelli will also give a full day lecture. I am particularly delighted that a series of workshops will also be presented on pre-conference day on various compliance issues such as health and safety, infection control, oral radiology and amalgam: an absolute must for any GDP! I am delighted to welcome back Dr Joe Omar (UK), Dr Susie Sanderson (UK), Dr Tif Qureshi (UK) and Dr Raj Rattan, the newly appointed Director of Dental Protection.

My sincere thanks also to all of our Irish speakers on this year's programme, without whose support we could not run this successful event. I am especially honoured to welcome Professor Peter Butler to our conference this year. He is a graduate of the Royal College of Surgeons in Ireland, and is the son of the late Professor Norman Butler, Past President of the IDA and for many years consultant in restorative dentistry at the Dublin Dental Hospital. We are delighted that Peter will dedicate his lecture to the memory of his late father who died recently, and who made a very significant contribution to Irish dentistry.

As every year, the dental trade show will showcase new and advanced products, equipment and technology from the dental industry. All members of the dental team will have the opportunity to discuss these products and services with trade colleagues. I urge you to support the trade at our event. As the IDA is the leading provider of CPD in Ireland, all lectures, presentations and workshops will be CPD certified.

No conference is complete without a varied and exciting social programme, including our golf competition at the beautiful Mount Juliet and, of course, our annual dinner on Friday evening. An interesting, fun and cultural city, Kilkenny will provide the ideal location for this year's Annual Conference. Be sure to put it in your diary: May 11-13, 2017.

I look forward to seeing you there.



Dr Robin Foyle, President Elect
An Dochtúir Robin Foyle, Uachtarán Tofa

NÓTA ÓN UACHTARÁN

A Chara Dhill,

Ba mhaith liom fáilte a chur romhaibh go dtí an comhdháil bhliantúil i 2017, thar ceann Cumann Fiaclóirí na hÉireann.

I mbliana, fillimid ar Chill Channaigh, Cathair na Marmar, a bhí go diall i 2014 nuair a bhíomar ann cheana. Tá cuireadh ann duitse agus dod' fhoireann ar fad chun freastal air thar trí lá agus smaointe nua a thabhairt thar nais dod' chleachtadh féin.

Ar an gclár eolaíochta, táimse ag súil go mór le cainteoirí le clú agus cáil a chlosaint ó chian is ó chóngar, ag caint ar ábhair suimiúla. Táim thar a bheith áthasach chun fáilte a chur roimh An Dr Stephen Buchanan, saineolaí ar fréamhacha a líonadh, UCLA, California, a bheidh ag tabhairt léachtaí lae dúinn ag an gclár réamh-comhdhála.

Beidh An tOllamh Jim Kessler, Ollscoil Oklahoma, ag tabhairt cúrsa ar aisig criadóireachta greamaithe agus beidh An Dr Kirk Pasquinelli, saineolaí ar na drandal, ag tabhairt léachtaí lae leis.

Tá ríméid orm go mbeidh sraith ranganna ar fáil ar an lá réamh-comhdhála ar ábhair éagsúla cosúil le sláinte agus sábháilteachta, smacht ar fhabhtú, raideolaíocht béil agus amalgaím. Bí ann gan teip!

Tá fíor áthas orm fáilte Uí Cheallaigh a chur roimh An Dr Joe Omar, An Dr Susie Sanderson, An Dr Tif Qureshi (An Ríocht Aontaithe) agus An Dr Raj Rattan, an Stiúrthóir nua ceapaithe ar 'Dental Protection'.

Mo mhíle buíochas dár gcainteoirí as Éireann i mbliana. Ní fhéadfaimis an chomhdháil a rith gan bhur dtacaíocht.

Is mór an onóir dom fáilte a chur roimh an tOllamh Peadar de Buitléir go dtí an chomhdháil i mbliana. Tá cáil domhanda air lena chuid oibre draíochtúil le hathtógaint an aghaidh agus máinliacht athdheilbhíthe. Is céim é ón RCSI, Baile Átha Cliath agus is mac é leis An tOllamh Norman de Buitléir nach maireann, iar Uachtarán Chumann Fiaclóirí na hÉireann.

Mar a bhíonn gach bliain, beidh taispeántas breá ag na comhlachtaí fiaclóireachta, ag taispeáint táirgí, uirlísí agus teicneolaíocht nua dúinn. Beidh deis ag an bhfoireann ar fad cúrsaí a phlé leis na comhlachtaí seo. Iarraim oraibh tacú leis na comhlachtaí seo ag an taispeántas.

Beidh na léachtaí, cur i láthair agus ranganna clúdaithe le CPD ag an comhdháil mar is gnáth.

Ní bheadh aon comhdháil i gceart gan clár sóisialta fairsing spleodrach a bheith ann. Beidh an comórtas gaif lonnaithe i Mount Juliet i mBaile Mhic Andáin agus beidh ár ndinnéar bhliantúil ar an Aoine.

Is cathair suimiúil í Cill Channaigh, lán de bheocht agus cultúr agus beidh sí ina suíomh oiriúnach don chomhdháil bhliantúil seo. Nā dein dearmad í a chur sa dialann idir 11-13 Bealtaine, 2017.

Táimse ag súil, sibh a fheiscint i gCill Channaigh i Mí Bealtaine 2017.



FUTURE-PROOF YOUR PATIENTS' ORAL HEALTH WITH COLGATE TOTAL®

- Superior antibacterial protection for 12 hours^{*,1,2}
- Significantly reduces bacterial load on hard and soft tissue^{**,2}

Visit us at **stand G4** to find out what is **new** at **Colgate®**

Clinically proven protection, Irish Dental Association approved



Colgate®

YOUR PARTNER IN ORAL HEALTH

www.colgateprofessional.ie

* Compared to a regular fluoride toothpaste – defined as non-antibacterial fluoride toothpaste.

** Defined as teeth, tongue, cheeks and gums.

1. Kravaphan P, Armonchat C, Triratana T. *J Clin Dent*. 2013;24:20–24.

2. Fine DH, Sreenivasan PK, McKiernan M et al. *J Clin Periodontol*. 2012;39:1056–1064.

INTRODUCTION

AGM

The Annual General Meeting of the Irish Dental Association and the Irish Dental Union will take place at 6.00pm in the McCurdy Suite on Thursday, May 11. All members are asked to attend.

REGISTRATION

All delegates **MUST** register at the registration desk. NO guests or unregistered delegates are permitted access to any part of the conference area including the trade show area.

CONFERENCE BADGES (No badge – no entry)

Please wear your name badge at all times. Conference badges must be worn to gain admittance to any session or the trade show area.

COURTESY

Please ensure that noise is kept to a minimum around the conference area during scientific sessions, so as not to disturb the session. Please ensure mobile phones are turned to silent during lectures.

LUNCHES

Lunch will be served in the main hotel restaurant.

ANNUAL DINNER

The Annual Dinner takes place on Friday, May 12. A drinks reception will take place in the front foyer at 7.00pm. Dress code is black tie. A seating plan will be in use.

CONFERENCE COMMITTEE



Billy Davis



Pat Cleary



Jane Renehan



Elaine Hughes

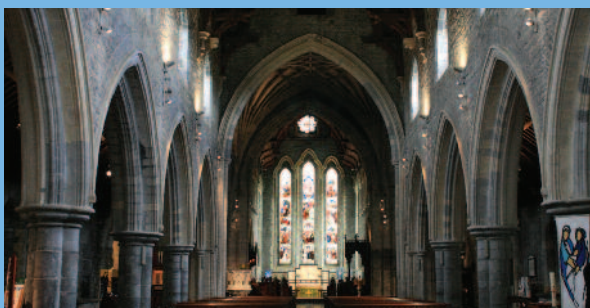

PROGRAMME COLOUR CODE AND CONTENTS

PRE-CONFERENCE PROGRAMME	6
WORKSHOPS	7
CONFERENCE	9
DENTAL TEAM PROGRAMME	9
DENTAL NURSES' PROGRAMME	10

2017 will see the re-introduction of the dedicated dental nurses' programme. Dental hygienists are welcome to attend any of the sessions on both Friday and Saturday.



Planning and delivering predictable bonded ceramic restorations

Dr James Kessler

Bonded ceramic restorations present the dentist with a broad spectrum of treatment options in aesthetically demanding situations. They also present the dentist with a new set of restorative challenges and techniques. It is imperative that we understand the various materials available, along with the indications and limitations of each.

In this course aspects of case selection, tooth preparation, provisional fabrication and restorative material options will be discussed. Participation exercises will consist of tooth preparations and provisional fabrication for anterior porcelain veneers and preparations for posterior-bonded onlay restorations.



At the completion of this course, participants will be able to:

- identify appropriate clinical situations for bonded porcelain restorations;
- understand the critical components of tooth preparations for anterior and posterior bonded ceramic restoration for both CAD/CAM-produced and traditionally fabricated restorations; and,
- design and fabricate provisional restorations for various bonded porcelain restoration preparations.

Hands-on full day



Beyond health: the aesthetics of the periodontium around teeth and implants

Dr Kirk Pasquinelli

These talks will deal with the three mainstays of periodontal plastic surgery – root coverage, crown lengthening, and implants in the aesthetic zone – and how they relate to the delivery of comprehensive aesthetic dentistry. Dental problems are often multifactorial in nature and may not be satisfactorily resolved by restorative treatment alone; therefore, an interdisciplinary approach to these situations offers the greatest potential for an outstanding treatment result. These presentations will illustrate how periodontal procedures can facilitate optimum aesthetic outcomes.



Section 1: Periodontal anatomy and crown lengthening surgery

This presentation emphasises periodontal anatomy and surgery as it relates to restorative dentistry. Topics include the biologic width of attachment, the dentogingival complex, root anatomy, prep design, and principles of aesthetic and surgical crown lengthening.

Section 2: Reconstructive periodontal plastic surgery

This presentation concentrates on the aesthetic improvements possible with reconstructive periodontal plastic surgery around teeth and dental implants. Topics include gingival augmentation and root coverage.

Section 3: Implants in the aesthetic zone

This presentation concentrates on the utilisation of implants in the aesthetic zone. Topics include immediate implants, staged implants, clinical parameters necessary for success with implants, and periodontal plastic surgery procedures to maximise the aesthetics of implants.

Lecture full day



The art of endodontics: everything has changed except the anatomy

Dr Stephen Buchanan

Morning: This presentation relates the most fundamental and unchanging endodontic issues – pulp, dentin, root, and root canal anatomy – to principles of treatment, simplifying our choices among evolving procedural technologies. A diagnostic regimen is shown that can definitively rule endo in or out, and if pain is of endo aetiology, it can definitively discover which tooth is referring the pain. The use of cone beam CT imaging is shown as a diagnostic as well as a treatment planning tool, finishing with a logical decision tree that clinicians can use when considering whether to save the tooth with further treatment or to replace it with an implant fixture.

After watching this presentation, attendees should understand:

1. The influence of endodontic anatomy on pulp degeneration and how the complexities of root canal systems dictate treatment to their full apical and lateral extents.
2. How 3D and 2D radiography with thermal pulp testing can deliver 100% diagnostic confidence.
3. How to plan emergency care, endo vs implant, and how you are going to successfully invade the patient's root canal systems.



Afternoon: The afternoon presentation shows Dr Buchanan's most current treatment methods, shot in HD through clear tooth replicas and during treatment of live patient cases. Procedures covered included guided-access cavities, rotary negotiation, shaping canals with one to three files, bug-jarring irrigation and 3D obturation accomplished in seconds.

After watching this presentation attendees should understand:

1. How cutting with guided access burs reduces loss of tooth structure while improving file paths.
2. How rotary negotiation brings the 10X improvement that rotary shaping did 15 years ago.
3. Why 3D obturation can improve success rates and how simple it is to do with today's technology.

Kerr™

Lecture full day

AN INSPECTOR CALLS. ARE YOU READY? – COMPLIANCE WITH REGULATIONS AND INSPECTIONS IN THE DENTAL SETTING**Dr Jane Renehan**

These workshops will focus on achieving compliance with regulatory bodies' inspections and prepare the dental practitioner for the inspector's knock on the practice door. Sessions will cover the key areas of safety and health at work, sharps regulations, infection prevention and control, water quality and amalgam separation, and radiation installations/licensing. Regulatory bodies such as the EPA (Office of Radiological Protection), HSA (Health & Safety Authority), HSE, HIQA, local authorities, etc., may inspect a dental premises resulting in a serious impact on business productivity. Delegates will be advised as to what an inspector may request and how the compliant practitioner should respond.

WORKSHOP 1 – MORNING OR AFTERNOON**Half day: 9.15am-12.30pm or 1.45pm-5.30pm****A: Infection prevention and control****Dr Nick Armstrong and Ms Siobhan Carrigan**

Since April 2015, the revised Code of Practice in Infection Prevention and Control by the Irish Dental Council has been in place. With this in mind,

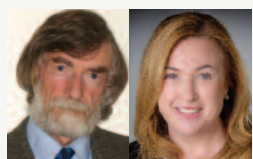

the IDA is offering its most comprehensive ever practical hands-on infection control workshops for all dental team members. With support from Henry Schein, a dental chair and full decontamination unit will be in situ and delegates will be walked through the entire process. A detailed explanation will be provided of good practice in equipment decontamination for the dental surgery and the sterilisation area, with guidance on regular testing processes and essential documentation, all linked with the new Code. It is the responsibility of all dental practitioners to ensure that their dental surgery and sterilisation processes are compliant with the new Code of Practice.

HENRY SCHEIN®

6.5 CPD POINTS
B: Water quality including amalgam separators**Ms Fiona Heavey**

With the support of DMI, this workshop will cover water quality. Dental unit waterlines must deliver potable water of an optimal microbiologic quality. Delegates will learn how practices should source, manufacture and store water, with information on advised monitoring processes to have in place to prove that quality checks are undertaken. In addition, delegates will review the requirements to ensure that clinical waste water leaving the dental premises complies with legislation, most especially with respect to the use of approved methods of amalgam separation.

**C: Health and safety at work, sharps regulations****Dr Eamon Croke**

This workshop will examine the authority a Health and Safety Authority (HSA) Inspector has in visiting a dental practice and will highlight what differentiates a HSA inspection from other potential practice inspections. Delegates will gain an insight into the scope of a HSA inspection as part of improving the safety, health and welfare of people at work. The workshop will review the HSA's website, BeSMART.ie, and appreciate how it can help in the generation of risk assessment and, ultimately, a customised practice safety statement. Attendees will learn what resources and competencies are required to pass a HSA inspection.

D: Radiation licensing**Ms Tanya Kenny**

The EPA (Office of Radiological Protection) is the competent authority in relation to the protection of workers and members of the public from the harmful effects of exposure to ionising radiation. Because of the potential health risks, the use of and exposure to ionising radiation is strictly regulated by Irish and European legislation. EPA inspectors regularly carry out inspections on dental premises. By law, all practices that use radioactive sources (such as an x-ray unit) must hold a valid licence from the EPA, and comply with the conditions set out in the licence's schedules. In this section of our workshop delegates will understand what current and prospective licensees need to know, including how to apply for a licence and an outline of the regulations and guidance material those who own or operate x-ray machines need to be aware of.

Half-day workshop**WORKSHOP 2: MEDICAL EMERGENCIES – MORNING OR AFTERNOON****Half-day course: 9.30am-1.00pm or 2.00pm-5.30pm****Recognition and management of medical emergencies in the dental practice – presented by Safe Hands**

This workshop is designed to update dental professionals on how to manage patients presenting with a medical/cardiac emergency while awaiting the ambulance service. It will address what medical emergency drugs are required and how these drugs are prepared and administered. Delivery will be provided through an interactive lecture and small group simulations/scenarios using a 'hands-on' approach addressing: choking; asthma; myocardial infarction; hypoglycaemia; seizure; and, anaphylaxis. On completion, participants will be able to:

1. Demonstrate recognition, assessment and treatment of the 'unwell' patient using a structured A, B, C, D, E approach.
2. Recognise and manage medical emergencies in the dental practice.
3. Demonstrate indication/contraindication, preparation and administration of emergency drugs – oxygen, Ventolin, GTN, aspirin, Glucagon, Hypostop, Diazepam and adrenaline.
4. Demonstrate awareness of legal, ethical and professional duty of care.

6 CPD POINTS
**Half-day workshop**
6.00pm IDU Annual General Meeting followed by IDA Annual General Meeting
Followed by trade show opening party

Solutions for better,
safer, faster dental care

Clinical Procedures
Preventive
Restorative
Orthodontics
Endodontics
Implants
Prosthetics

Platform Technologies
CAD/CAM
Imaging Systems
Treatment Centers
Instruments

www.dentsplysirona.com

Dentsply and Sirona have joined forces to become the world's largest provider of professional dental solutions. Our trusted brands have empowered dental professionals to provide better, safer and faster care in all fields of dentistry for over 100 years. However, as advanced as dentistry is today, together we are committed to making it even better. Everything we do is about helping you deliver the best possible dental care, for the benefit of your patients and practice.

THE DENTAL
SOLUTIONS
COMPANY™

**Dentsply
Sirona**

Wrigley's Extra.

Another way to improve your patients' oral health



Significant changes in lifestyle mean that traditional eating habits have altered, and people are now eating on the go more than ever before. The more we snack, the more our teeth come under attack.

Independent clinical research proves that chewing sugarfree gum for 20 minutes after eating or drinking helps neutralise the plaque acid attacks that can cause tooth decay* and contributes to removing food remains*.

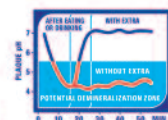

Increased flow of saliva also promotes the remineralisation of tooth enamel,* thus reducing one risk factor for developing tooth decay**.

Chewing sugarfree gum after eating and drinking helps neutralise plaque acids, assisting in keeping teeth clean and healthy. ^{1,2,3,4,5,6,7,8,9,10,11,12,13,14,15,16,17,18,19,20,21,22,23,24,25,26,27,28,29,30,31,32,33,34,35,36,37,38,39,40,41,42,43,44,45,46,47,48,49,50,51,52,53,54,55,56,57,58,59,60,61,62,63,64,65,66,67,68,69,70,71,72,73,74,75,76,77,78,79,80,81,82,83,84,85,86,87,88,89,90,91,92,93,94,95,96,97,98,99,100}

Help your patients improve their oral health through one extra simple and enjoyable step – recommend Wrigley's Extra®.

To learn more about the science behind the benefits of sugarfree gum visit www.wrigleyoralhealthcare.ie

WRIGLEY
Oral Healthcare
Programme



*Alcantara F, Lavelle G, McMahon K, Atkin S. Benefits of Chewing (Dental Oral Health and Beyond). Nutrition Today. Volume 43, Number 9, March/April 2008. **Leach SA, et al. Remineralization of artificial caries-like lesions in human enamel in vitro by chewing xylitol gum. J Dent Res 1989;68:1064-9. ***Caton J, et al. The effect of chewing gum use on in vitro enamel lesion remineralization. J Dent Res 1992;71:1395-9. ****Hewings E, et al. The effect of chewing sugarfree gum after meals on clinical caries incidence. J Am Dent Assoc 1989;119:1823-6. *****Sokal J, et al. Effect of after-meal sucrose-free gum-chewing on clinical caries. J Dent Res 2001;80:1725-9. **Extra® sugarfree gum is beneficial for dental health as it helps neutralise plaque acids.



CONFERENCE PROGRAMME

FRIDAY MAY 12

PROGRAMME 1	MCCURDY 2	PROGRAMME 2	MCCURDY 3
9.00am – 10.00am	A look at new restorative materials through the lens of proven principles James Kessler	9.00am – 10.00am	Getting back to basics – oral surgery Justin Moloney
10.00am – 10.45am	“That looks like a tooth!” How to make an implant-supported crown look natural Kirk Pasquinelli	10.00am – 10.45am	Interceptive orthodontic treatment. Is it worthwhile? John Walsh
10.45am – 11.15am	COFFEE BREAK	10.45am – 11.15am	COFFEE BREAK
11.15am – 12.00pm	Interpreting radiographs Eric Whaites	11.15am – 12.00pm	The approaching dental tsunami in nursing homes Anne Twomey
12.00pm – 12.30pm	IDA governance - an update PJ Byrne	12.00pm – 1.00pm	When to hold, when to fold Stephen Buchanan
12.30pm – 1.00pm	Antimicrobial resistance – whose problem is it? Susie Sanderson		
1.00pm – 2.00pm	LUNCH	1.00pm – 2.00pm	LUNCH
2.00pm – 2.45pm	Dental Team Programme Medical emergencies Joe Omar	2.00pm – 2.45pm	Preparation designs and laboratory communication James Kessler
2.45pm – 3.30pm	Tales of the unexpected Raj Rattan	2.45pm – 3.30pm	Evidence-based use of composite resin in dentistry Michael O’Sullivan
3.30pm – 4.00pm	COFFEE BREAK	3.30pm – 4.00pm	COFFEE BREAK
Both programmes will merge for the last two presentations – two fascinating speakers/topics not to be missed by any dental team member			
4.00pm – 4.45pm	10 critical success factors in general dental practice: personal reflections Raj Rattan		
4.45pm – 5.45pm	Facial transplantation and beyond: extending the boundaries of facial reconstruction Peter Butler		

Kerr

7 CPD POINTS

IDA
journal of the irish dental association
Iris Cumainn Déantach na hÉireann





ANNUAL CONFERENCE 2016



LEFT: At the Annual Dinner were (from left): Dr Bill Cosgrove, Mr Colm Davitt, Dr Maura McGuinness and Mr Pat O'Brien. RIGHT: Dr Dermot Canavan was one of the speakers in Galway at the 2016 Annual Conference.

CONFERENCE PROGRAMME

SATURDAY MAY 13

PROGRAMME 1		MCCURDY 2	PROGRAMME 2	MCCURDY 3
10.00am – 11.00am	Management of soft tissue complications around dental implants Kirk Pasquinelli		10.00am – 11.00am	Is caries a problem? Dan Ericson 
11.00am – 11.30am	COFFEE BREAK		11.00am – 11.30am	COFFEE BREAK
11.30am – 12.15pm	First tooth, first visit, zero cavities Eleanor McGovern 		11.30am – 12.00pm	Oral cancer – what am I looking for? Pat Ormond
12.15pm – 1.00pm	Policy options and advocacy for reducing our sugar intake Modi Mwatsama		12.00pm – 1.00pm	Snoring patients and dentist pre-treatment screening Roy Dookun
1.00pm – 2.00pm	LUNCH		1.00pm – 2.00pm	LUNCH
2.00pm – 2.45pm	Cosmetic dentistry vs simple interceptive, aesthetic and functional dentistry Tif Qureshi		2.00pm – 2.45pm	Trigeminal nerve injuries associated with dentistry – who is at risk and how are they managed? Dermot Canavan
2.45pm – 3.30pm	Anticoagulants and their implications for dental treatment Sheila Galvin		2.45pm – 3.30pm	New technology in endodontics Stephen Buchanan 
3.30pm – 4.00pm	COFFEE BREAK		3.30pm – 4.00pm	COFFEE BREAK
Both programmes will merge for the last presentation –				
4.00pm – 4.45pm	The transition to full dentures: why, how and what to expect Ed Cotter			

DENTAL NURSES' PROGRAMME

SATURDAY MAY 13

PROGRAMME	MAGINNES SUITE
10.00am – 10.45am	Social media and the dental practice Dental Protection
10.45am – 11.15am	TEA/COFFEE
11.15am – 12.00pm	Assisting the oral surgeon Justin Moloney
12.00pm – 12.45pm	Infection control Siobhan Carrigan
12.45pm – 1.45pm	LUNCH
1.45pm – 2.30pm	Behavioural management and the role of the dental nurse John Walsh
2.30pm – 3.30pm	Dealing with the older patient Anne Twomey

HELP KEEP YOUR PATIENTS ON A JOURNEY TO HEALTHY GUMS

CORSODYL® TOOTHPASTE IS CLINICALLY PROVEN TO REDUCE PLAQUE, BLEEDING GUMS AND INFLAMMATION

4X

greater plaque removal*¹

48%

greater reduction in bleeding gums*¹

Recommend Corsodyl® Toothpaste to help patients maintain their gum health between dental visits.



*Removes more plaque than a regular toothpaste after a professional clean and twice daily brushing.

Reference: 1. Data on file, GSK, RH02434, January 2015.

Trade marks are owned by or licensed to the GSK group of companies.

CHGBI/CHCSYL/0134/16

DR JOE MOLONEY AWARD



Dr Pat Cleary, endodontist, Dublin (left), receiving the Dr Joe Moloney Award for 2016 from Dr Paddy Crotty (centre), Irish Dental Health Foundation, and Dr PJ Byrne, President of the IDA.

The Dr Joe Moloney Award is awarded to an outstanding Irish presenter/lecturer at our conference, chosen by the delegates. The winner of the Award, which is kindly sponsored by the Dental Health Foundation, will be chosen on the final day of the Conference, when all delegates will have the chance to nominate their presenter of choice.

DR TONY COSTELLO MEMORIAL MEDAL



Dublin Dental University School and Hospital students Claire McGleenon (left) and Safoora Shahab receiving the Costello Medal from Dr PJ Byrne, President of the IDA, at the 2016 Annual Conference in Galway.

The competition for the Tony Costello Memorial Medal will be judged on a Table Demonstration or Poster Presentation of not more than 10 minutes on a subject applicable to general dental practice. Each of the three dental schools may enter a team of a maximum of two people. The presentation will be judged on:

- clinical usefulness;
- academic content;
- presentation; and,
- originality.

The Irish Dental Association will provide a grant for each demonstration.

Friday, May 12

ANNUAL PRESIDENT'S DINNER 2017

7.00pm Drinks reception

8.15pm Dinner followed by entertainment by The Keynotes

Tickets €85

All dental team members, trade members and friends welcome



Visit DMI at the IDA Annual Conference 2017

Stand G3 May 11th - 13th

DMI is delighted to be Gold Sponsors of the IDA Annual Conference 2017. Visit us at Stand G3, a dedicated area specially reserved for practical demonstrations including:

- Tips on dental chair and handpiece maintenance and how to avoid costly repairs
- Conducting oral cancer exams
- How to take the perfect X - Ray
- Hand hygiene in dentistry
- What essentials should be included in your emergency kit?

DMI will also be sponsoring Thursday's workshop on 'Water quality including amalgam separators'. Please see main programme for full details.

Visit DMI at stand G3 to explore all your surgery possibilities and discover the latest innovations in dentistry.



DR NICK ARMSTRONG
Former Principal Dental Surgeon,
HSE, and member of the IDA's Quality
and Patient Safety Committee

Infection prevention and control

Since April 2015, the revised Code of Practice in Infection Prevention and Control by the Irish Dental Council has been in place. With this in mind, the IDA is offering its most comprehensive ever practical hands-on infection control workshops for all dental team members. With support from Henry Schein, a dental chair and full decontamination unit will be in situ and delegates will be walked through the entire process. A detailed explanation will be provided of good practice in equipment decontamination for the dental surgery and the sterilisation area, with guidance on regular testing processes and essential documentation.



DR STEPHEN BUCHANAN
Endodontist, California

When to hold, when to fold

Treatment planning an endodontically treated tooth that may require re-treatment vs extracting that same tooth and placing an implant.

New technology in endodontics

TrueVision 3D camera system, drill guides for endo, XNav real-time guided endo, endo beyond tiles: NIT, Sonendo, and PIPS.



PROFESSOR PETER BUTLER
Professor of Plastic Surgery, University
College London

**Facial transplantation and beyond:
Extending the boundaries of facial
reconstruction**



DR DERMOT CANAVAN
Specialist in orofacial pain management,
Dublin and King's College London

**Trigeminal nerve injuries associated with
dentistry – who is at risk and how are they
managed?**

This lecture will review the pathogenesis and clinical characteristics of trigeminal nerve injuries that may occur as a result of dental treatment. It will examine the factors that place some patients in a higher risk category than others.



MS SIOBHAN CARRIGAN
Senior Dental Nurse, HSE Dublin

Infection prevention and control

Since April 2015, the revised Code of Practice in Infection Prevention and Control by the Irish Dental Council has been in place. With this in mind, the IDA is offering its most comprehensive ever practical hands-on infection control workshops for all dental team members. With support from Henry Schein, a dental chair and full decontamination unit will be in situ and delegates will be walked through the entire process. A detailed explanation will be provided of good practice in equipment decontamination for the dental surgery and the sterilisation area, with guidance on regular testing processes and essential documentation.



DR EDWARD COTTER
Practice limited to prosthodontics,
maxillofacial prosthetics and dental
oncology, Dublin

**The transition to full dentures: why, how and
what to expect**

This presentation will cover the reasons for a transition to full dentures, the possible methods of making the transition, the expected physiological and functional outcomes, and the psychological outcomes for your patients.



DR EAMON CROKE
GDP, Dublin

Health and safety at work, sharps regulations

This workshop will examine the authority a Health and Safety Authority (HSA) Inspector has in visiting a dental practice and will highlight what differentiates a HSA inspection from other potential practice inspections. Delegates will gain an insight into the scope of a HSA inspection as part of improving the safety, health and welfare of people at work. The workshop will review the HSA's website, BeSMART.ie, and appreciate how it can help in the generation of risk assessment and, ultimately, a customised practice safety statement. Attendees will learn what resources and competencies are required to pass a HSA inspection.



DR ROY DOOKUN
GDP with a special interest in sleeping disorders, Guernsey, Channel Islands

Snoring patients and dentist pre-treatment screening

The lecture will explain: why OSA screening is essential prior to treating any snoring patient; the current position regarding the examination and diagnosis of snoring patients; the benefits of pragmatic, target population screening and how this can be refined using limited channel ambulatory investigations; other reasons why OSA screening may be of interest to GDPs; why pre-treatment screening involves more than just 'OSA screening'; the side effects of oral appliance therapy; the importance of paediatric OSA screening; and, the possible role of specialist dental practitioners.



PROFESSOR DAN ERICSON
Chairman of Cariology, Faculty of Odontology, Malmö University, Sweden

Is caries a problem?

This lecture will elaborate on the fact that caries is the world's most common disease driven by our craving for sweets. Sugar consumption will not only bring about decay of teeth, but also decay of general health – sugar is a common risk factor for obesity, diabetes, etc. We can slow down the caries process to some extent by adding fluoride to a cosmetic (toothpaste), but still, all caries cannot be controlled. Are we happy with that as professionals? Do patients think caries is a problem? Can we deal with it by placing restorations?



DR SHEILA GALVIN
Consultant in Oral Medicine, Dublin Dental University Hospital

Anticoagulants and their implications for dental treatment

This presentation will cover the common anticoagulants in current use. While pharmacology, interactions and indications for use will be touched on, the focus will be on the relevance for dental treatment, and any adjustments or precautions that should be taken prior to and during treatment.



MS FIONA HEAVEY
Clinical Manager and Dental Nurse, Dublin

Water quality including amalgam separators

With the support of DMI, this workshop will cover water quality. Dental unit waterlines must deliver potable water of an optimal microbiologic quality. Delegates will learn how practices should source, manufacture and store water, with information on advised monitoring processes to have in place to prove that quality checks are undertaken. In addition, delegates will review the requirements to ensure that clinical waste water leaving the dental premises complies with legislation, most especially with respect to the use of approved methods of amalgam separation.



MS TANYA KENNY
Project Manager, Environmental Protection Agency (Formerly RPII)

Radiation licensing

The EPA (Office of Radiological Protection) is the competent authority in relation to the protection of workers and members of the public from the harmful effects of exposure to ionising radiation. The use of and exposure to ionising radiation is strictly regulated by Irish and European legislation. By law, all practices that use radioactive sources (such as an x-ray unit) must hold a valid licence from the EPA, and comply with the conditions set out in the licence's schedules. In this section of our workshop delegates will understand what current and prospective licensees need to know, including how to apply for a licence and an outline of the regulations and guidance material those who own or operate x-ray machines need to be aware of.



DR JAMES C. KESSLER

Retired Professor and Director of Advanced Esthetics and Technology, University of Oklahoma College of Dentistry. Owner, High Country Dental Arts Laboratory

A look at new restorative materials through the lens of proven principles

Participants will learn how to: understand the physical properties for all-ceramic materials; determine the most appropriate restorative material and design for each situation; and, recognise the clinical situations where traditional restorations may still be the best option.

Preparation designs and laboratory communication – what your laboratory technician needs to provide the best results

Learn to establish methods to communicate critical information to the dental laboratory.



DR ELEANOR MCGOVERN
Paediatric Dentist, Dublin

First tooth, first visit, zero cavities

This presentation will focus on the year one dental visit. It will also review the challenges and practicalities of managing dental care of young children.



DR JUSTIN MOLONEY
Oral Surgeon, Dublin

Getting back to basics – oral surgery

This presentation will highlight assessment, instrumentation, equipment, set-up technique, postoperative care and costs associated with minor oral surgery in practice, to make practitioners more confident when extracting teeth. A number of case studies will be demonstrated using video.

Assisting the oral surgeon



MS MODI MWATSAMA

Registered Nutritionist and Director of Policy and Global Health at the UK Health Forum

Policy options and advocacy for reducing our sugar intake

This presentation will:

- provide an overview of the global sugar production and consumption trends and drivers;
- highlight examples of population-level actions to reduce sugar, with a focus on the evidence and examples of implementation;
- illustrate some of the opportunities and challenges to implementation, including areas of convergence and conflict between public health and industry objectives; and,
- outline recent developments and progress on sugar reduction in the UK.



DR JOE OMAR

Senior Partner at Sedation Solutions Ltd, Senior Clinical Teaching Fellow, Eastman CPD, UCL

Medical emergencies

Cardiovascular disease and diabetes remain the most important causes of medical emergencies in dental practice. This presentation will cover the causes and management of heart attack, cardiac arrest and the management of diabetic emergencies.



DR PATRICK ORMOND

Consultant Dermatologist, Dermatological and Mohs Micrographic Surgeon, St James's Hospital, and the Hermitage Medical

Oral cancer – what am I looking for?

This presentation will cover the range of melanoma and non-melanoma skin cancers with particular reference to presentation on the face and neck. The presentation will help practitioners to recognise intra-oral and extra-oral dermatological conditions and highlight the importance of conducting a head and neck exam.



DR MICHAEL O'SULLIVAN
Associate Professor/Consultant in
Restorative Dentistry, Dublin Dental
University Hospital

Evidence-based use of composite resin in dentistry

This presentation will enable practitioners:

- to understand the role of rubber dam in adhesive dentistry;
- to understand the principles of optimal cavity design for composite resin;
- to identify the challenges of restoring proximal cavities; and,
- to evaluate techniques for composite resin placement



DR KIRK PASQUINI
Private practice in periodontics, aesthetic
and pre-prosthetic oral surgery, as well as
dental implants

"That looks like a tooth!" How to make an implant-supported crown look natural

The peri-implant soft tissue form delineates the ultimate appearance of the gum line around an implant-supported crown. This talk will explain how this tissue form is dependent on the crown contours in order to assume the most natural shape.

Management of soft tissue complications around dental implants



DR TIF QURESHI
IAS Academy, UK

Cosmetic dentistry vs simple interceptive, aesthetic and functional dentistry

This lecture will cover:

- progressive vs conventional smile design protocols – a question of ethics;
- Little's study and the missing piece in the breakdown of dentition;
- controlling and returning guidance with orthodontic appliances and 3D printing for prediction;
- direct bonding for aesthetics, splints, treatment of wear and control of guidance – the Dahl principle; and,
- digitally planned, align bleach and bond for aesthetic and functional value.



DR RAJ RATTAN
Director, Dental Protection

Session 1: 10 critical success factors in general dental practice: personal reflections

This session will cover aspects of practice management that most contribute to creating a successful practice. Raj will explore a range of issues from the perspective of personal, professional and business success.

Session 2: Tales of the unexpected: a review of medico-legal cases and the lessons that can be learned from them

Raj will present a number of dento-legal cases and explore the root causes and the risk management lessons that can be learned from them. The selected cases will provide insight into risk management in the areas of consent, record keeping and the management of human error.



DR JANE RENEHAN
Principal Dental Surgeon, Dublin

Infection prevention and control

Since April 2015, the revised Code of Practice in Infection Prevention and Control by the Irish Dental Council has been in place. With this in mind, the IDA is offering its most comprehensive ever practical hands-on infection control workshops for all dental team members. With support from Henry Schein, a dental chair and full decontamination unit will be in situ and delegates will be walked through the entire process. A detailed explanation will be provided of good practice in equipment decontamination for the dental surgery and the sterilisation area, with guidance on regular testing processes and essential documentation.



DR SUSIE SANDERSON
GDP and Dento-legal Adviser, Dental
Protection

Antimicrobial resistance – whose problem is it?

This presentation will describe the reasons why antimicrobial resistance is a global problem and will argue that dentistry has a responsibility and opportunity to play its part in its reduction. Antimicrobial stewardship campaigns will be briefly described, along with examples of successful intervention programmes in primary care dentistry. An overview of the management of dental infections in primary dental care will include a discussion about the challenges and perverse incentives that dentists face in achieving an appropriate use of antibiotics. Can the use of clinical audit to measure prescribing practice and management of dental infection against published guidelines improve a clinician's risk management?



DR ANNE TWOMEY
General dental practitioner with a special interest in care of the elderly

The approaching dental tsunami in nursing homes

This lecture will focus on the rapidly changing dental picture of patients in nursing homes. It will highlight the problems, possibilities and solutions for patients who are unable to attend the dental surgery in the usual way. It aims to increase the dental profession's awareness of the changing needs of the older population and the need for dentists to work within the multidisciplinary team. It will also discuss managing patients' experiences and expectations, and how to incorporate this service into general practice to achieve best clinical outcomes.

Dealing with older patients

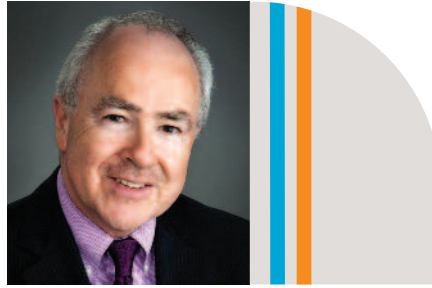

DR JOHN WALSH
Paediatric Dentist and Orthodontist

Interceptive orthodontic treatment. Is it worthwhile?

The purpose of this presentation is to discuss the ways in which the developing occlusion in the child patient can be influenced. Both normal and abnormal development will be described and possible lines of treatment will be detailed. The evidence to support such treatment will be analysed and the practical techniques that can be used will be illustrated.

Behavioural management and the role of the dental nurse



DR ERIC WHAITES
Honorary Consultant in Dental and Maxillofacial Radiology, King's College London Dental Institute

Interpreting radiographs

Who wants to be an oral radiologist? Interpreting oral radiology using an interactive quiz.

ACCOMMODATION IN KILKENNY

Aspect Hotel, Ring Rd, Kilkenny 056-778 3100	Conference hotel Lyrath House Hotel, Paulstown Rd, Kilkenny 056-776 0088	Ormonde Hotel, Ormonde Street, Kilkenny 056-775 0200	River Court Hotel, John Street, Kilkenny 056-772 3388	Springhill Court Hotel, Waterford Rd, Kilkenny 056-772 1122
Wednesday May 10/ Thursday May 11 Single B&B €49 Double B&B €59	All nights of conference Single €120 Double/Twin €150	Wednesday May 10/ Thursday May 11 Single €80 Double €90	All nights of conference Single €108 Double €118	Wednesday May 10/ Thursday May 11 Single €65 Double/Twin €75
Friday May 12 Single B&B €89 Double B&B €99		Friday May 12 Single €130 Double €140		Friday May 12 Single €115 Double/Twin €125



THE DENTAL HUB

A new addition to our Annual Conference this year is the Dental Education Hub. On Friday and Saturday, May 12 and 13, in association with DMI Ireland, the IDA will hold short, informal educational sessions where delegates can sit in and take home some practical ideas for better practice.

The format of the presentations will be 15 minutes of learning on practical everyday topics. Delegates registered for the Conference can choose to pop in to these sessions as they wish throughout the programme. Different topics will have different relevance for different delegates – you decide!

Sessions will be quick, snappy and informative, and the idea is that the participant leaves the hub with a new skill or piece of information to bring back to their surgeries!

Try them and see!

DENTAL HUB TIMINGS

FRIDAY

10.30am – 10.45am	5 top tips for maintaining equipment
11.30am – 11.45am	Oral hygiene tips for your patients
12.15pm – 12.30pm	Amalgam separation - Minamata
12.45pm – 1.00pm	Handpiece maintenance



SATURDAY

10.30am – 10.45am	Hand hygiene in dentistry
11.30am – 11.45am	What should be included in my emergency drug kit?
12.15pm – 12.30pm	Dental Protection presentation
2.00pm – 2.15pm	An oral cancer exam
2.45pm – 3.00pm	Getting the most from your intra-oral x-rays



Southern Cross Dental, your full service dental laboratory and partner in clinical excellence.

Visit us at stand **B3**.

KIN DENTAL PRODUCTS

VISIT US ON STAND B2

and enter a draw
to win one of
three Kin dental
stands with
€300 of Kin
dental products.



SOCIAL PROGRAMME



PRESIDENT'S GOLF COMPETITION

Mount Juliet

The President's Golf Competition will take place at the spectacular Mount Juliet Golf & Country Club from 12 noon on Thursday, May 11. For anyone booked on a pre-conference course on Thursday, we can accommodate you on Wednesday May 10 to play golf.

As well as conference delegates, accompanying persons and trade exhibitors are welcome to play. Only registered delegates can be eligible for the President's Prize.



TRADE SHOW OPENING PARTY

McCurdy Suite

The "Satisfy your Curiosity" trade show party will be officially opened by the newly inaugurated IDA President Dr Robin Foyle at approximately 8.00pm directly after the AGM in the trade show area.

All delegates and trade sponsors are invited to attend. Fun, music and drinks will be provided for all.

Come along and enjoy the party!



ANNUAL DINNER

McCurdy Suite

The Annual Dinner will take place on Friday, May 12. A drinks reception will commence at 7.00pm followed by dinner and entertainment. Dress code is black tie. Tickets are €85 and are available from IDA House. All dental team members, trade members and friends are welcome to attend.



PAST PRESIDENTS' LUNCH

The Past Presidents lunch will take place at 1.00pm on Saturday, May 13 (venue to be confirmed).



Exclusive insurance products for IDA members

Motor Insurance

Home Insurance

Dental Practice Insurance

Call Aidan Mahon in Doyle Mahon Insurances with your IDA Membership Number to avail of these savings

Email: aidan@doylemahon.ie
Tel: 053 91 23630
Mobile: 087 7618574
Web Address: www.doylemahon.ie

Doyle Insurance Brokers (Wexford) Ltd. T/a Doyle Mahon Insurances, is regulated by the Central Bank of Ireland. Registered Office: 5 Skeffington Street, Wexford, Registered Number: 463420.

Zirkonzahn®

THE THIRD DIMENSION IN PATIENT ANALYSIS

FACE HUNTER

Facial scanner for the 3D digitisation of the patient's face

PLANESYSTEM®

For the exact determination of the patient's occlusal plane

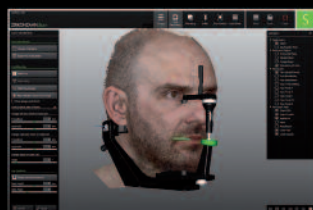

Zirkonzahn Worldwide – South Tyrol (Italy) – T +39 0474 066 680
info@zirkonzahn.com – www.zirkonzahn.com

RESTORATION HIGHLIGHT KIT



Syringe Kit shown.
Tips Kit also available

The perfect way to try NEW COLTENE materials and **save over 50%** on buying individually!



Restoration Highlight Kit - Syringes

ART# 6002 0090

3 x BRILLIANT EverGlow Syringes (3g) (1 x A1/B1, A2/B2, A3/D3),
1 x One Coat 7 Universal Bond 5ml +50 brushes,
2 DIA TECH ShapeGuard brushes for composite (1 x pre-polisher and 1 high lustre)

Restoration Highlight Kit - Tips

ART# 6002 0091

30 BRILLIANT EverGlow Tips 0.2g, 10 tips of each (A1/B1, A2/B2, A3/D3),
1 x One Coat 7 Universal Bond 5ml +50 brushes,
2 DIA TECH ShapeGuard brushes for composite (1 x pre-polisher and 1 high lustre)

LOOK FOR US ON SILVER STAND 8

IDA CONFERENCE 2017

Call: +44(0)1444 235486

INFO.UK@COLTENE.COM WWW.COLTENE.COM



COLTENE
THE BRANDS YOU TRUST

TRADE SHOW

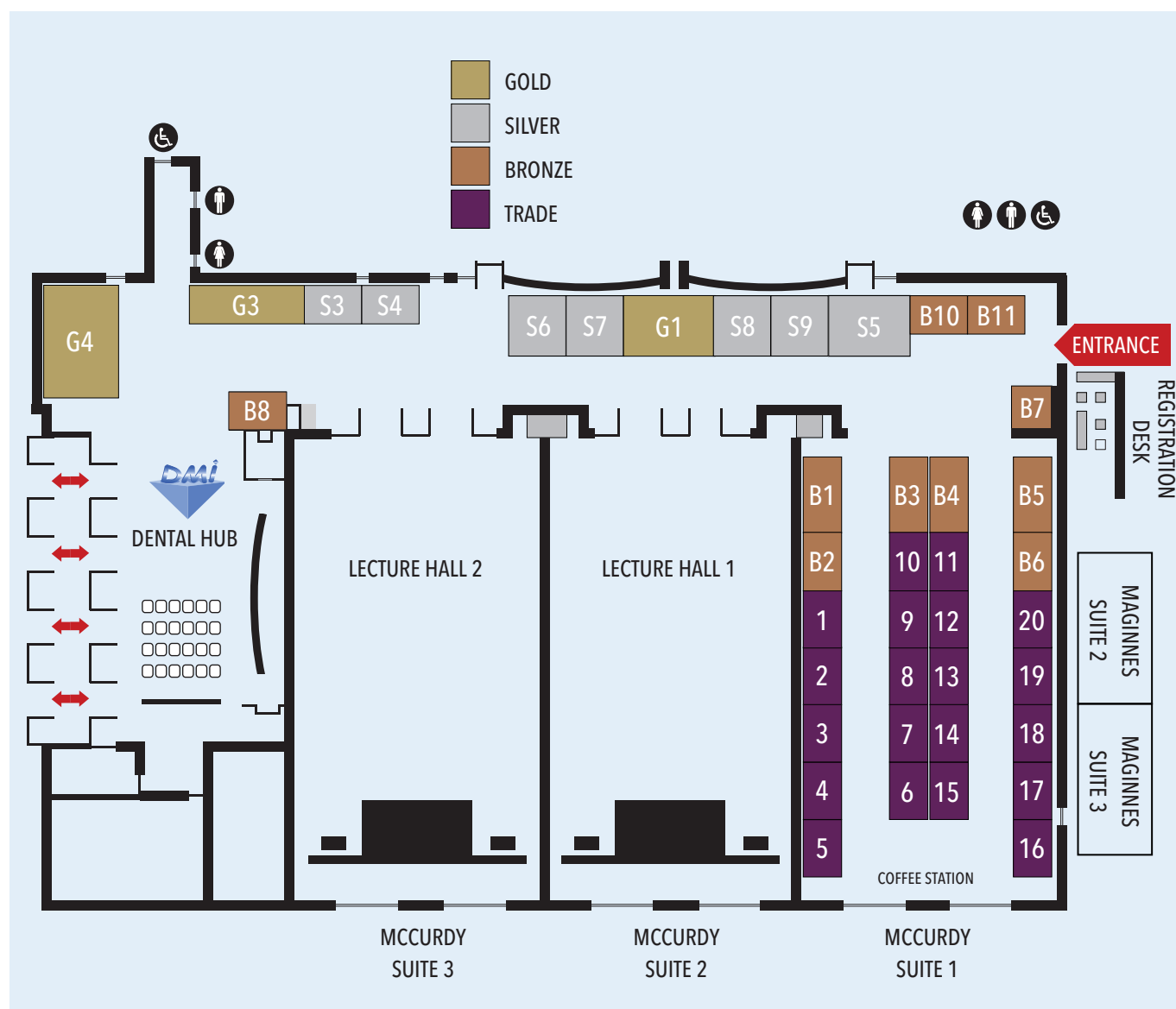

LIST OF EXHIBITORS

GOLD

G1	GSK
G3	DMI
G4	Colgate

SILVER

S3+S4	Swordfish Medical
S5	Dentsply Sirona
S6	Johnson and Johnson
S7	Dentawearth
S8	Coltene
S9	Wrigley
B10+B11	Promed

BRONZE

B1	Henry Schein
B2	Pamex Ltd
B3	Southern Cross Dental
B4	Cerezen
B5	Medaccount Services
B6	Zirkonzahn
B7	Nobel Biocare
B8	Zimmer Biomet

TRADE

1	Hereaus Kulzer
2	Dentech
3	IDT
4	Doyle Mahon
5	DeCare Dental Insurance Ireland
6	Kerr
7	Moore Wealth Management Ltd
8	Initial Medical
9	Q-SIP
10	Septodont UK Ltd
11	Omega Financial Management
12	Handpiece Harry
13	Optident
14	Dental Protection
15	3M
16	Karma Sales and Services
17	TePe
18	Southern Implants
19	McDowell + Service Dental Laboratory
20	NSK



Q-Optics
Made in the USA



12 MONTHS INTEREST FREE FINANCE AVAILABLE*

www.swordfishmedical.com

paro[®]+



SWISS MADE SINCE 1969

*Term and conditions apply



Dentawealth
Wealth Management Service

**Providing Strategic Financial Planning,
Wealth and Capital Management.**

- » Protection of Assets
- » Capital Management
- » Extraction of Wealth
- » Investments
- » Tax Reduction
- » Risk Management
- » Volatility Management
- » Inheritance Tax Planning
- » Retirement Planning
- » Advice to Dental Professionals
- » Insurance & Non Insurance Solutions
- » Investment & Insurance Audits
- » Strategies to take money out of your business tax free

T 01 4584327 E info@dentawealth.ie
www.dentawealth.ie

Walfrid
PRIVATE

Brought to you by Walfrid Private Ltd. Walfrid Private Ltd.
t/a Dentawealth is regulated by the Central Bank of Ireland.

Digital workflow is one of our core competencies



Henry Schein ConnectDental provides expert advice for digital solutions, including education and support to help dental professionals operate more productively and deliver superior patient care.

HENRY SCHEIN
ConnectDental®

Trusted
Digital
Solution

For more information about our Henry Schein ConnectDental Trusted Digital Solutions, please contact Dublin 01 456 0286, Cork 021 429 7818 or email sales@henryschein.ie

**Will you still be smiling
at the end of the year?**

Make sure your practice is profitable in 2017

As Ireland's only specialist dental accountants we're here to help you control your practice costs

QUARTERLY ACCOUNTS

PAYROLL SERVICES

TAX CONSULTANCY

COST OF TREATMENT

MedAccount offer a full range of specialist dental accounting support and advisory services for Associates, Principals, Expense Sharing Partners and Hygienists.

MedAccount Services

96 Lower Georges Street
Dun Laoghaire
Co Dublin

Tel: 01 280 6414

Email: info@medaccount.ie



First consultation ~~FREE OF CHARGE~~ with no obligation to engage

STAND B10

**Introducing
The iTero
Intraoral
Scanner**

PROMED
A PARTNERSHIP IN PRACTICE

iTero®



**ARE YOU INTERESTED
IN PROVIDING SLEEP
SOLUTIONS FOR
YOUR PATIENTS?**

→ Promed presents •

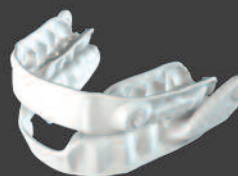

Narval™ CC

ResMed

ANNUAL CONFERENCE – MAY 11-13, LYRATH HOUSE HOTEL KILKENNY

PRE-CONFERENCE COMBINATIONS –

Please indicate your choice(s) by ticking relevant box

All delegates must register online for this year's conference. To register, log in to www.dentist.ie with your username and password. Then select "Book CPD Event" from the menu bar. If you are not a member, go to www.dentist.ie and select "Book CPD Event" from the menu bar and enter your email and password.

If you are encountering any problems please contact Gráinne on 01-295 0072.

	MEMBERS		NON-MEMBERS	
Pre-conference Courses				
FULL DAY/ HANDS ON				
<input type="checkbox"/> JIM KESSLER – RESTORATIVE	SOLD OUT	<input type="checkbox"/> €500	<input type="checkbox"/> €1000	
FULL DAY/ LECTURE				
<input type="checkbox"/> KIRK PASQUINELLI – PERIODONTICS		<input type="checkbox"/> €300	<input type="checkbox"/> €600	
FULL DAY/ LECTURE				
<input type="checkbox"/> STEPHEN BUCHANAN – ENDODONTICS		<input type="checkbox"/> €300	<input type="checkbox"/> €600	
HALF DAY/ WORKSHOP				
<input type="checkbox"/> COMPLIANCE AM/PM		<input type="checkbox"/> €300	<input type="checkbox"/> €600	
HALF DAY/ WORKSHOP				
<input type="checkbox"/> MEDICAL EMERGENCIES AM/PM		<input type="checkbox"/> €245	<input type="checkbox"/> €490	
Main Conference Only				
	Member	Non-Member	Student	IDA Life Member
<input type="checkbox"/> Full Conference	<input type="checkbox"/> €400	<input type="checkbox"/> €800	<input type="checkbox"/> €270	<input type="checkbox"/> €220
<input type="checkbox"/> One Day of Conference	<input type="checkbox"/> €300	<input type="checkbox"/> €600	<input type="checkbox"/> €180	<input type="checkbox"/> €170
Dental Team				
<input type="checkbox"/> Dental Team x 1	<input type="checkbox"/> €170			
<input type="checkbox"/> Dental Team x 2	<input type="checkbox"/> €250			
<input type="checkbox"/> Dental Team x 3	<input type="checkbox"/> €340			
<input type="checkbox"/> Dental Team x 4	<input type="checkbox"/> €430			
Discounted Packages				
<input type="checkbox"/> Package 1 Restorative + 1 Day Main Conference	SOLD OUT	<input type="checkbox"/> €720	<input type="checkbox"/> €1,440	
<input type="checkbox"/> Package 2 Restorative + Main Conference	SOLD OUT	<input type="checkbox"/> €800	<input type="checkbox"/> €1,600	
<input type="checkbox"/> Package 3 Periodontics + 1 Day Main Conference		<input type="checkbox"/> €520	<input type="checkbox"/> €1,040	
<input type="checkbox"/> Package 4 Periodontics + Main Conference		<input type="checkbox"/> €600	<input type="checkbox"/> €1,200	
<input type="checkbox"/> Package 5 Endodontics + 1 Day Main Conference		<input type="checkbox"/> €520	<input type="checkbox"/> €1,040	
<input type="checkbox"/> Package 6 Endodontics + Main Conference		<input type="checkbox"/> €600	<input type="checkbox"/> €1,200	
<input type="checkbox"/> Package 7 Compliance AM/PM + 1 Day Main Conference		<input type="checkbox"/> €520	<input type="checkbox"/> €1,040	
<input type="checkbox"/> Package 8 Compliance AM/PM + Main Conference		<input type="checkbox"/> €600	<input type="checkbox"/> €1,200	
<input type="checkbox"/> Package 9 Medical Emergencies AM/PM and Compliance AM/PM Workshops		<input type="checkbox"/> €450	<input type="checkbox"/> €900	
<input type="checkbox"/> Package 10 Medical Emergencies AM/PM and Compliance AM/PM + 1 Day Main Conference		<input type="checkbox"/> €650	<input type="checkbox"/> €1,300	
<input type="checkbox"/> Package 11 Medical Emergencies AM/PM and Compliance AM/PM + Main Conference		<input type="checkbox"/> €750	<input type="checkbox"/> €1,500	
<input type="checkbox"/> Package 12 Medical Emergencies AM/PM + 1 Day Main Conference		<input type="checkbox"/> €465	<input type="checkbox"/> €930	
<input type="checkbox"/> Package 13 Medical Emergencies AM/PM + Main Conference		<input type="checkbox"/> €545	<input type="checkbox"/> €1,090	
Social Programme				
<input type="checkbox"/> Dinner	<input type="checkbox"/> €85			
<input type="checkbox"/> Golf Wed/Thurs	<input type="checkbox"/> €65			

Online bookings will close at midnight on Tuesday, May 9, 2017.
Bookings must be made on site after this date.

SOCIAL ACTIVITIES

PRESIDENT'S GOLF COMPETITION



The President's Golf Competition will take place at Mount Juliet on Thursday May 11, from 12.05pm. For anyone booked to do a pre-conference course, you will be accommodated to play on Wednesday, May 10, in the afternoon.

Tee time: from 12.05pm
Green fees: €65

Playing in three balls.

As well as conference delegates, accompanying persons and all trade exhibitors are also welcome to play. Only registered delegates can be eligible for the President's Prize.

TRADE SHOW PARTY

Thursday May 11, following the AGM.

All delegates and trade show partners welcome.



Clockwise from top left: Gerry Lavery on the Septodont stand at last year's trade show; Nick McKelvie (left) and Jesse Morrow of McDowell + Service; Dr Noelle Cobbe from Limerick was one of the many visitors to the Henry Schein stand where she met with field sales consultant Patrick Bolger (left) and equipment sales specialist Jim Way.

TOP TEN REASONS TO JOIN THE IDA



1 Save money

So many services you buy will be less expensive, including substantial savings on your professional indemnity costs.



6 Wise advice

The IDA provides professional advice at no charge to members on HR, employment and practice management issues on a daily basis.



2 Strength in numbers

Over 85% of dentists are members: that's what makes us stronger.



7 Mentoring

If you are new to the profession, you can avail of the IDA mentoring service – and if you are experienced, you can volunteer your services.



3 Networking

The social side of the IDA is great and it's very important to members. Friendship is an integral part of membership.



8 Dental Complaints Resolution Service

Everyone encounters complaints. If you can't resolve it, the DCRS will help – and there's no charge for members.



4 Education and science

We offer IDA members a wealth of hands-on, practical courses, lectures and free access to our branch meetings, plus significant discounts for our Annual Conference and other scientific meetings.



9 Making your voice heard

We are committed to advocacy on behalf of the profession and your patients by working closely with other stakeholders committed to promoting better oral health.



5 Professional solidarity

Membership of the Association also means membership of the Irish Dental Union, the trade union for dentists, which allows us to defend and represent dentists on important issues.



10 Continuous learning

We offer exclusive access to members-only CPD. We also offer members access to our new learning management system to book and record your CPD online.



irish dental association

IRISH DENTAL ASSOCIATION
Unit 2 Leopardstown Office Park, Sandyford, Dublin 18
T +353 1 295 0072 F +353 1 295 0092
www.dentist.ie